

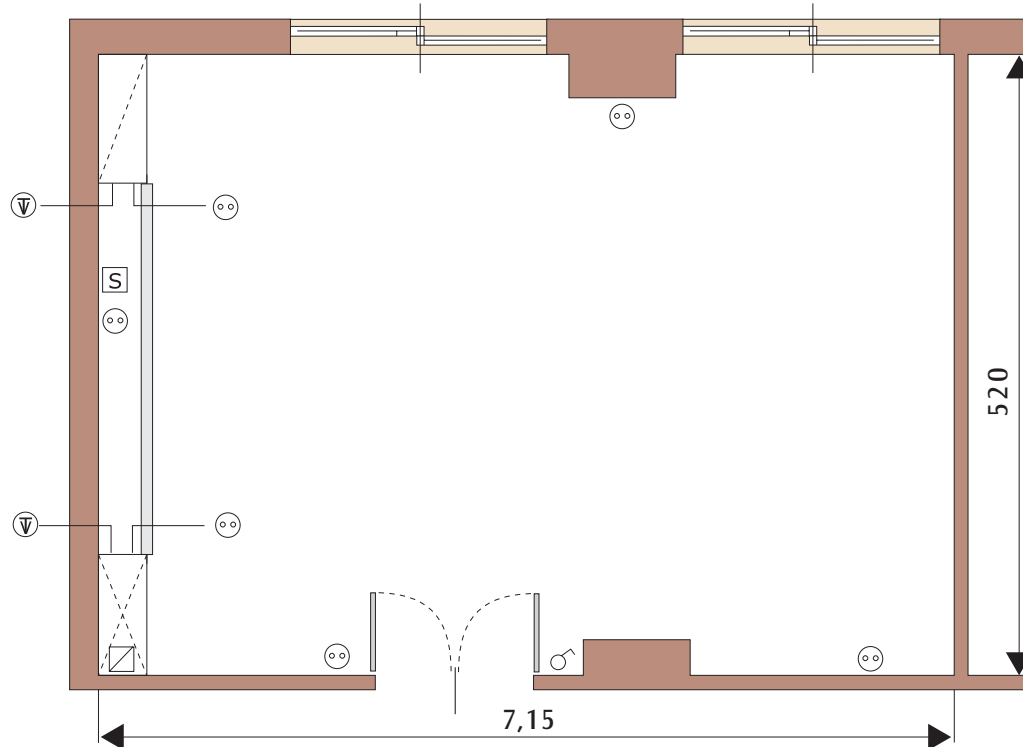

## Hotel Michelangelo Milano

# DELLA ROVERE MEETING ROOM



### Key:

- ☎ microphone socket    ♂ light switch    S screen control    TV TV socket    ⊙ electrical socket  
☎ telephone plug    T curtain control    PC PC socket    ☒ telephone connection box

### Characteristics:

Length: 7,15 metres    Width: 5,20 metres    Height: 2,70 metres    Area: sq.mtr.37

### The meeting room charge includes:

WiFi Connection (under request), lector table with wired microphones, wireless microphones, audio system, laser ray of light (under request), external desk ( with telephone and Surgiva mineral water - **Subject to availability**).

### Maximum number of people for the type of arrangement:

Theatre style	Theatre desk	Classroom style	U-shape style	Closed U-shape style	One Table style	Cabaret Style 6 pax		Banks with tables round 10 pax	Defilè	Seated Buffet	Standing Buffet
						T.Square	T.Round				
max 30	max 20	max 18	max 15	max 18	max 12					-----	-----

### Direct contacts:

Meeting Centre Office - Hotel Michelangelo Milan  
Piazza Luigi di Savoia, 6 - 20124 Milano  
Tel: 026755865 - Fax. 026694132  
E-mail Address: [michelangelo.convegni@milanhotel.it](mailto:michelangelo.convegni@milanhotel.it)